

REVISIONS		
DATE	NAME	NO.
FEB. 1, 1988	ROBERT C. BOGART	15474
NOV. 17, 1998	ROBERT C. BOGART	15474
MAR. 4, 2004	ROBERT C. BOGART	15474
DEC. 13, 2004	ROBERT C. BOGART	15474
DEC. 3, 2005	ROBERT C. BOGART	15474
DEC. 2015	CARL M. HERRMAN	42271

SEE 1

SEE 2

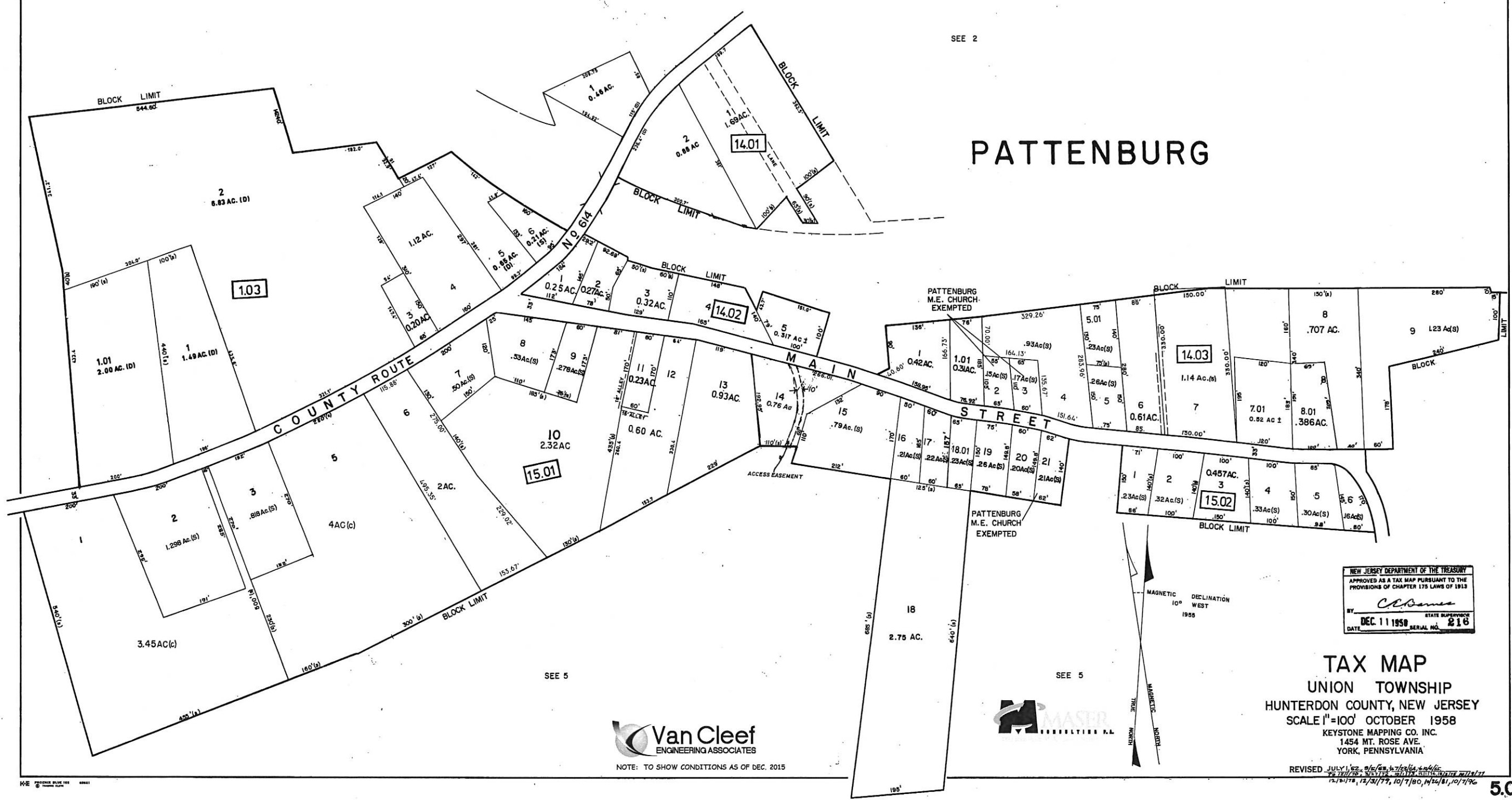

SEE 5

SEE 5

Van Cleaf
ENGINEERING ASSOCIATES

NOTE: TO SHOW CONDITIONS AS OF DEC. 2015

NEW JERSEY DEPARTMENT OF THE TREASURY
APPROVED AS A TAX MAP PURSUANT TO THE PROVISIONS OF CHAPTER 175 LAWS OF 1913
BY: *C. J. Jones*
STATE SUPERVISOR
DATE: DEC. 11 1958 SERIAL NO. 218

TAX MAP
UNION TOWNSHIP
HUNTERDON COUNTY, NEW JERSEY
SCALE 1"=100' OCTOBER 1958
KEYSTONE MAPPING CO. INC.
1454 MT. ROSE AVE.
YORK, PENNSYLVANIA

REVISED JULY 1, 52, 9/6/58, 3/7/59, 4/4/60, 7/27/78, 9/23/78, 10/11/80, 11/24/81, 10/1/90, 12/31/77, 10/1/80, 11/24/81, 10/1/90